

BEAR CREEK WATER ASSOCIATION



P. O. Box 107
Canton, MS 39046

Phone: (601) 856-5969
Fax: (601) 856-8936

E-mail: nwilliamson@bcwaterms.org

January 21, 2015

Mr. Rudy Warnock, P.E.
County Engineer
P.O. Box 1623
Canton, MS 39046

RE: Utility Permit Application
Force Main at Stribling Road Extension
Bear Creek Water Association, Inc.

Dear Mr. Warnock,

Enclosed is a permit application to install a PVC force main along Stribling Road Extension west of its intersection with Church Road. This force main will allow us to connect to our proposed Stone Creek pump station and provide service to a new residential subdivision, Stone Creek. Also, enclosed is a CD containing a PDF copy of the permit application.

Your earliest review and approval of these applications would be appreciated. If you have any questions or need additional information, please give us a call.

Sincerely,



Nolan P. Williamson, P.E.
Engineering Manager

Enclosures

UTILITY PERMIT STATUS	
<input checked="" type="checkbox"/> FIELD REVIEW	Review TIME 7 Am DATE 1-29-15
<input type="checkbox"/> ELECTRONIC REVIEW	DATE
COMMENTS	
<input checked="" type="checkbox"/> APPROVED <input type="checkbox"/> DENIED	
PRESENTED TO BOARD OF SUPERVISORS	
DATE	

MADISON COUNTY, MISSISSIPPI
PERMIT APPLICATION FOR USE AND OCCUPANCY
FOR THE CONSTRUCTION OR ADJUSTMENT OF A UTILITY
WITHIN ROAD OR HIGHWAY RIGHT-OF-WAY

FACILITY ALONG OR ACROSS MADISON COUNTY
 ROAD PROJECT NAME OR NUMBER STRIBLING ROAD EXT. COUNTY OF
 MADISON, BEGINNING IN SECTION 20, TOWNSHIP 8-N, RANGE
2-E, AND ENDING IN SECTION 20, TOWNSHIP 8-N, RANGE
2-E. UTILITY NAME Sewer BY Bear Creek Water Association, Inc.
 PHONE 601-856-5969 ADDRESS P.O. Box 107 Canton, MS 39046.

herein called APPLICANT, purposes to construct on Stribling Road Extension a
 (Name of Road)

Utility Facility installed between station Catlett Road and station
Church Road of Project Name / Number Stribling Road Extension and within

road or highway right-of-way, and hereby makes application to the County for a
 construction permit. Attached hereto are drawings or plans for the construction, which
 will not be changed or altered without approval of the Road Manager, or his
 representative.

Whereas, the Legislature of Mississippi has heretofore granted to the applicant the right
 to locate its facilities upon, across, under, over and along public highways and streets within the
 State of Mississippi; Applicant agrees to comply with applicable provisions of S.O.P. No. SAD
 II-2-8, Policy for the Accommodation of Utility Facilities within the Rights-of-Way of County
 Federal Aid and State Aid Highways (hereinafter referred to as the "Policy"), promulgated by the
 State Aid Engineer and dated January 1, 1983, and which is hereby made a part of this
 application Agreement, and agrees to perform the construction according to the applicable
 industry code and according to the plans and specifications for the Project.

The Applicant shall comply with all policies, procedures and construction practices as
 outlined in "A Policy for The Accommodation of Utility Facilities within the Right-of-Way of all

Public County Roads", as adopted on May 1, 1992, by the Madison County Board of Supervisors.

The Applicant shall be responsible for the future maintenance and repair of the facilities. The Applicant shall make future adjustments in, or relocate, the facilities located within road or highway right-of-way when required for road or highway widening or other road or highway construction at no cost to the county. The Applicant Utility shall relocate said utilities within sixty (60) days of notification by County by registered mail, return receipt requested, unless otherwise designated by the County's Road Manager. Further, any maintenance, repair, or construction shall be done in such a manner as to occasion no unreasonable interference with the normal flow and safety to traffic and at the expense of the utility company. When reasonable care has been taken to locate said utility facilities within the right-of-way, the applicant understands that any damages caused by routine maintenance and construction by county forces shall be borne by the applicant Utility.

A general description of the size, type, nature, and extent of the Utility work to be done is as follows:

We are submitting this permit application to allow the association to install 589 L.F. ± of 8" CL 160 PVC sewer force main in the south right-of-way of Stribling Road Extension between the entrances to Stone Creek Subdivision and Wellington Northwind Subdivision and 1438 L.F. ± of 8" CL 160 sewer force main from the entrance to Wellington Northwind to the tie-in point.

The applicant understands and agrees that, except as herein granted, no right, title, claim, or easement to said road right-of-way is granted by the issuance of this permit and if this Utility Facility as listed in the general provisions of the Policy, it will be adjusted to comply with same without cost to the County, unless the variance from the Policy has been approved by the granting of the Permit pursuant to this Application.

The Applicant further understands that the Utility's engineering, plant, or other personnel will be responsible for the staking and construction supervision of the work set out above and as shown on the attached plans.

The applicant further agrees to indemnify and hold county harmless for any and all claims, accidents, damages, liabilities and expenses occasioned wholly, or in part, by any act or omission of applicant, its agents or employees. In case County shall, without fault on its own part, be made a party to any litigation commenced by or against applicant, then applicant shall protect and hold County harmless, and shall pay all costs, expenses and reasonable attorney's fees incurred or paid by County in connection with said litigation.



1"=200' HORIZ.

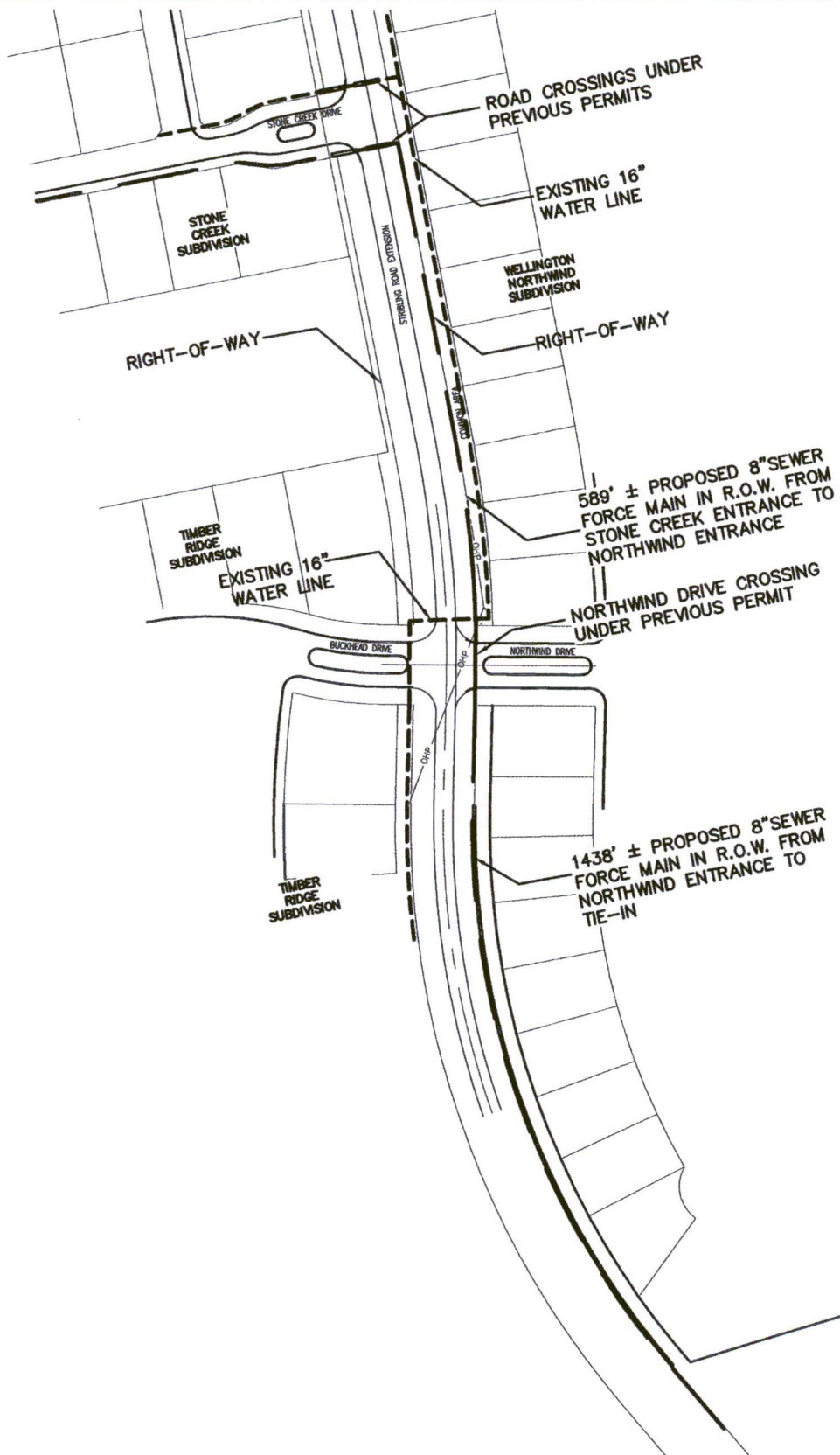

STRIBLING ROAD EXTENSION FORCE MAIN
FOR STONE CREEK SUBDIVISION.